

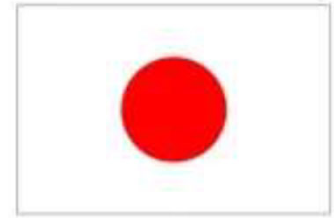

PHNOM PENH CAPITAL HALL



# 3<sup>rd</sup> ASEAN-JAPAN : Smart Cities High Level Meeting

## Phnom Penh Smart City Initiatives

Presented by:  
**Mr. Vannak Seng**  
Phnom Penh Capital Hall  
Director of Administration

18<sup>th</sup> -19<sup>th</sup> October 2021



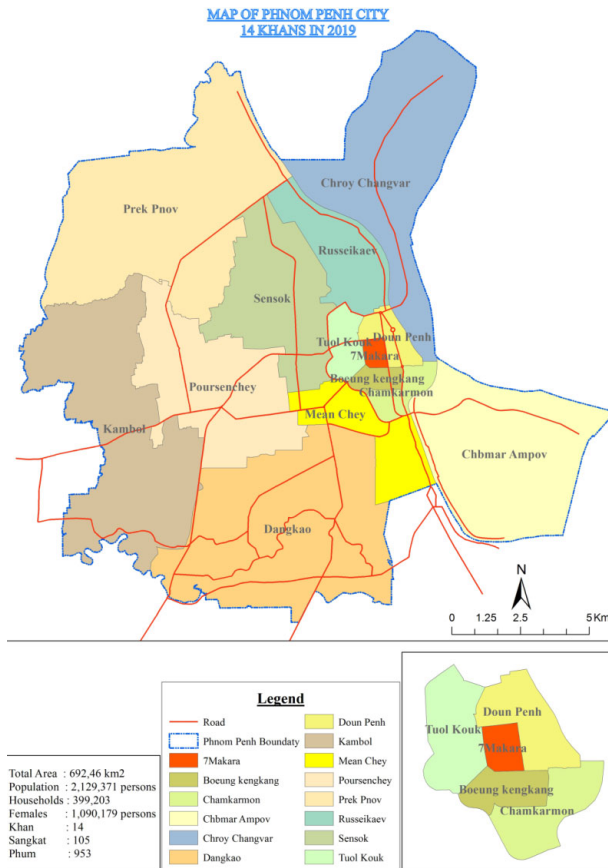

- Surface: 695,49 Km<sup>2</sup>
- Population:
  - 2008 = 1,327,615
  - 2019 = 2.281.951 (General Population Census of Kingdom of Cambodia 2019) or 14.7% of the total population.
- Annual Growth rate:
  - 2008 = 2.8%
  - 2019 = 4.9% (General Population Census of Kingdom of Cambodia 2019)
- Density
  - 2008= 2,212/sq.km
  - 2019= 3,361/sq.km (General Population Census of Kingdom of Cambodia 2019)
- Division Area: 14 districts, 105 Communes



# Vision, Focus Area and Strategic Targets

## Vision

- **To improve the urban environment to enhance citizen's quality of life**

## Focus Areas

- **Built Infrastructure**: Phnom Penh city needs resilience and efficient infrastructure serving current and future city growth.
- **Quality Environment**: Phnom Penh city needs a good public space design creating a healthy environment and boosting economic growth.
- **Civic and Social**: Develop a civic engagement through social media and applications to crowd source suggestions for the improvement of public space and public transport.

## Strategic Targets

- **Sustainable Environment**: Improve pedestrian mobility by providing attractive and walkable paths.
- **High Quality of Life**: Redesign public spaces for greater build accessibility between people and business.
- **Sustainable Environment**: Improve the efficiency of Phnom Penh public bus services to achieve 50% modal share.



# Smart City Project #1: 11 Sidewalks Rejuvenation



PHNOM PENH CAPITAL HALL

## Progress of the Project

- 3/11 important boulevards rehabilitation are undergoing with new tree planting (Monivong, Russian and Preah Sisovath).
- Another 3 main boulevards are in designing stage (Kampucheakrom, Monireth, Mao Tse Tong).
- Installation of CCTV camera and smart lighting with distance management from city control centers.
- Detailed studies on pedestrian connectivity and mobility of Preah Sisowath Quay.
- Further studies to integrate the 13-Boulevard project to public transport hub and public space in favor of mobility facilitation.
- Creation of Phnom Penh, Smart and Sustainable City Strategic Road Map 2020-2035.





# Smart City Project #1: 11 Sidewalks Rejuvenation

## **Challenges to Implementation**

- Surveillance-camera network, which is a component of data management, has not been properly managed to be put in place together.
  - Civilians living along the 11 Boulevards have used the pedestrian sidewalks as private properties and lacks public order management.
  - The amount of private cars has been continuously increasing and has been using pedestrian sidewalks as parking.
  - Smart equipment such as Smart light bulbs and sensors prices are still of high cost.
- Some studies process such as public hearing is disturbed due to the pandemic of Covid-19.

## **Partnerships and Support Required**

- Funding support to create incentives for street vendors to relocate or to organize food centers.
- Investment on public parking facilities.





# Smart City Project #1: 11 Sidewalks Rejuvenation

## Project # 1 11 Sidewalks Rejuvenation







# Smart City Project #1: 11 Sidewalks Rejuvenation (Cont.)

## Project # 1 11 Sidewalks Rejuvenation

### Phnom Penh – MinebeaMitsumi – (PPP)



### Phnom Penh – AIMF & EU

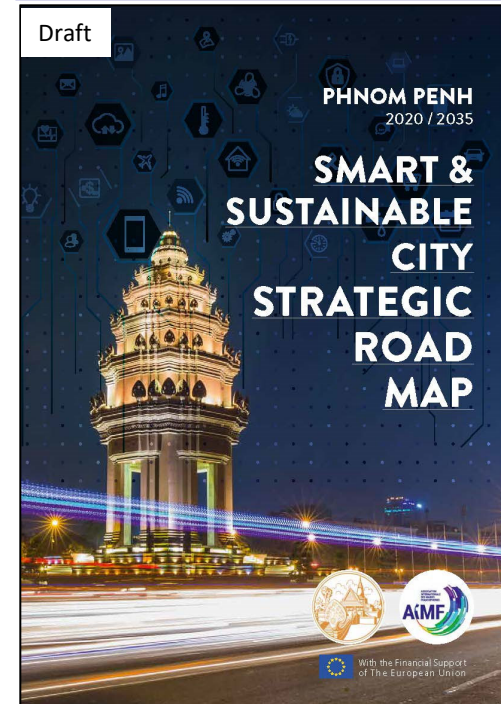



## Progress of the Project

- Thirteen bus-routes was in operation (activity postponed due to the pandemic of Covid-19).
- Introduced of non-cash payment system (card, smartpone, QR code) and real-time traffic tracking via mobile application.
- Built a traffic control center in Phnom Penh City Hall.
- Eased traffic congestion and public bus's fluidity by designing priority lanes for bus.
- Feasibility study on city's first AGT system.
- Detailed study on integrated urban transport and interconnected-transport hub with ADB.
- Collaboration between city and universities to tackle current traffic issue.
- Creation of Phnom Penh, Smart and Sustainable City Strategic Road Map 2020-2035.
- Start a new project on "Formulation Study on Smart Bus Shelters" as part of Smart JAMP's initiative between Phnom Penh and MLIT (Ministry of Land, Infrastructure, Transport and Tourism) of Japan.







## **Challenges to Implementation**

- The amount of private owned vehicles increased reducing the effectiveness of using bus services.
- Communication network connection with provincial buses is yet to be in place.
- Lack of public linkage facilities between household's location and bus stop (bicycle sharing services).
- Other mass transit facilities, which could motivate urban usage as AGT is at high cost of investment.
- Postpone of activities and its expansion due to the pandemic of Covid-19.

## **Partnerships and Support Required**

- Capacity building for public transport staff and enhance traffic control system.
- Support for City Bus Autonomous to strengthen its operation capacity.





PHNOM PENH CAPITAL HALL

# Smart City Project #2: Improving Efficiency of Phnom Penh Public Transport

## Project # 2 Public Transport Development Efficiency

លោកអ្នកអាចបង់ថ្លៃសេវា  
រថយន្តក្រុងរាជធានីភ្នំពេញ  
តាមរយៈអេស៊ីលីដាទាន់ចិត្ត

www.acledubank.com.kh | 023 954 444 | 015 999 233



### ផែនទីគម្រោងប្រតិបត្តិការដឹកជញ្ជូនក្រុងភ្នំពេញ ២០១៨

តម្រូវការផ្គត់ផ្គង់ / កំណត់ប្រតិបត្តិការ / រយៈពេលចេញដំណើរ

ខ្សែទី១	: ឡានព្រៃកញ្ជ័រ - ចំណតស្រះបាណ្ឌវ
ខ្សែទី២	: ចំណតស្រះបាណ្ឌវ - រង្វង់មូលដ្ឋាន
ខ្សែទី៣	: ចំណតស្រះបាណ្ឌវ - ប្រាំសង្កាត់
ខ្សែទី៤	: ចំណតស្រះបាណ្ឌវ - ប្រាំសង្កាត់/ អង្គស្នួល/ រង្វង់មូលដ្ឋាន
ខ្សែទី៥	: ស្ថានីយមេឃត្រកូលព្រៃកញ្ជ័រ - ឡានព្រៃកញ្ជ័រ
ខ្សែទី៦	: រង្វង់មូលដ្ឋាន - ចំណតស្រះបាណ្ឌវ
ខ្សែទី៧	: ចំណតស្រះបាណ្ឌវ - ចំណតស្រះបាណ្ឌវ
ខ្សែទី៨	: រង្វង់មូលដ្ឋាន - ឡានព្រៃកញ្ជ័រ
ខ្សែទី៩	: ប្រាំសង្កាត់ - ចំណតស្រះបាណ្ឌវ
ខ្សែទី១០	: ឡានព្រៃកញ្ជ័រ - ចំណតស្រះបាណ្ឌវ
ខ្សែទី១១	: ព្រៃស្រែ - ព្រះបាទស៊ីហមព្រហ្ម
ខ្សែទី១២	: កាយសំបុកស្រះបាណ្ឌវ - រង្វង់មូលដ្ឋាន
ខ្សែទី១៣	: រង្វង់មូលដ្ឋាន - រង្វង់មូលដ្ឋាន

រយៈពេលចេញដំណើរ

០៨:៣០	៨:១០	៨:៣០	៨:៥០	៩:១០
១០:៣០	១០:៥០	១១:១០	១១:៣០	១១:៥០

ការណែនាំ

- ដាក់ប្រាក់ទូលក្ខណៈប្រើប្រាស់
- ត្រូវប្រើប្រាស់ប្រាក់បញ្ញើ
- តំលៃសំបុក
- ទំនិញ: សំបុកម៉ុងហ្គោល, កាត់កាត់, កាត់កាត់, កាត់កាត់

Cash Wing Weell TeamChat

App ប្រើប្រាស់ជាមួយថ្លៃក្រុង

Stops Near Me

App Store Google Play



# Smart City Project #2: Improving Efficiency of Phnom Penh Public Transport



PHNOM PENH CAPITAL HALL

## Project # 2 Public Transport Development Efficiency

### Phnom Penh – Japan JICA

Traffic Control Center

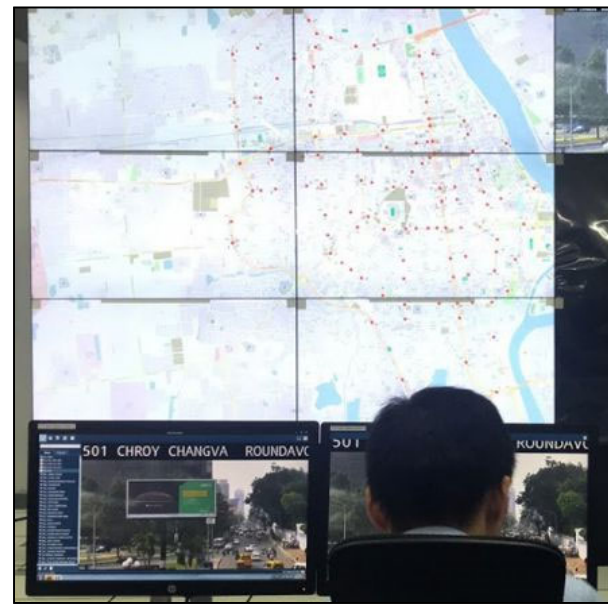

### Phnom Penh – Japan MLIT

Smart Bus Shelter (To be designed)





# Smart City Project #2: Improving Efficiency of Phnom Penh Public Transport



PHNOM PENH CAPITAL HALL

## Project # 2

## Public Transport Development Efficiency

### Phnom Penh – ADB

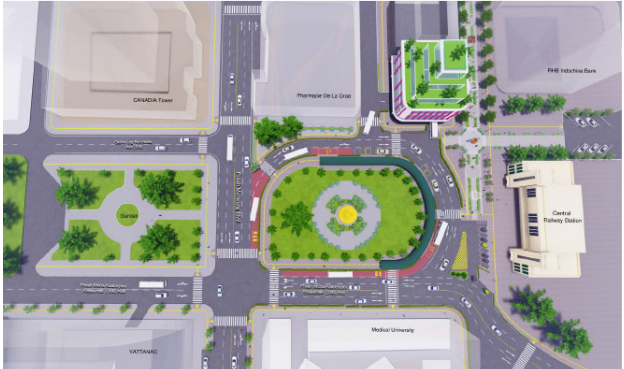

# Questions and Answers



PHNOM PENH CAPITAL HALL



Thank you !

